

NUOVA SIMONELLI AURELIA WAVE VOLUMETRIC 3 GROUP

The global espresso standard. Quality production.
Quality performance. Quality coffee.

FEATURES + BENEFITS

- Delivering more of everything you need - more hot water, more steam, more coffee, whilst maintaining the high quality Nuova Simonelli is famed for.
- Style and substance - The Aurelia Wave doesn't just look great, its been designed to make service efficient for the most demanding coffee professionals. From the user friendly controls to the raised group heads, the Aurelia Wave is designed from the bottom up with the barista in mind.
- Adaptability meets reliability - with controllable parameters, you can adapt the Aurelia Wave around your needs. Thanks to the TFT graphic display, making changes is easier than ever. This advanced technology is encased in the highest quality materials, built by Nuova Simonelli's expert team in Italy making it as reliable as it is versatile.
- Key features - Ergonomic design, eco-sustainability, automatic cleaning, built in volumetric dosing, soft infusion system and cool touch push / pull steam wand.



KEY STATISTICS

| **Number of groups:** 3

| **Power (watts):** 5200

| **Boiler size (litres):** 17

Product code: 10184

**NUOVA SIMONELLI
AURELIA WAVE VOLUMETRIC 3 GROUP**

The global espresso standard. Quality production.
Quality performance. Quality coffee.

CAPACITY AT PEAK



CAPACITY PER DAY



RECOMMENDED PRODUCTS

Nuova Simonelli Mythos One Grinder
Product code: 8425

COFFEEWORKS Barista Pack



Water connection	1-5 BAR isolated 15mm feed, 3/4" BSP screw fitting	
Filter type	Brita Purity 600/1200 C50	
Waste	1.5" downpipe to P-trap, minimum length 8"	
Power (watts)	5200	
Boiler size (litres)	17	
Power requirements	As standard 1 x 230Vac 32A single phase commando socket	
Breaker	C	
Weight (kg)	95	
Dimensions w x d x h (mm)	1032 x 605 x 537	

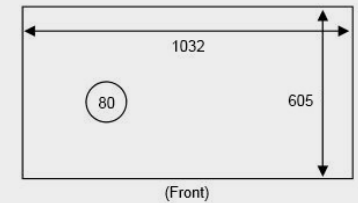
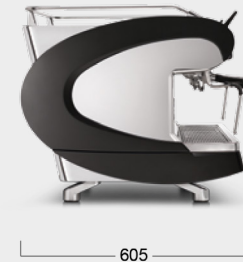

Hole is required through the counter